

WHY CHOOSE ROYAL CNC COLLET CHUCKS?

Superior Design Features

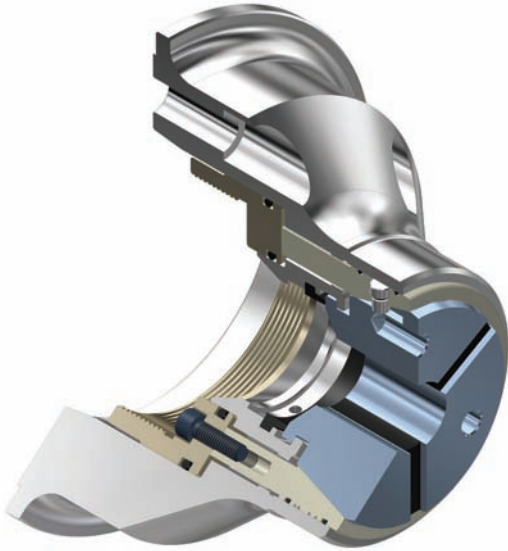

- ❑ All Royal CNC collet chucks have been optimized for maximum tool clearance and outstanding rigidity.
- ❑ Exclusive Bolt & Go™ Mounting Feature – **Dead On, Dead Accurate – Every Time!** See below for additional information.
- ❑ The closing sleeve connection on our Accu-Length™ models ensures zero backlash – a common problem on competitive chucks.
- ❑ Extremely close-fitting components and multiple O-ring seals make Royal CNC collet chucks the best sealed chucks available.
- ❑ Royal manufactures and stocks a wide range of adapter plates, stops, ejectors, and sealing devices so we can quickly and easily meet customer requirements.

Exclusive Royal Bolt & Go™ Mounting Advantage Because Your Time is Valuable!

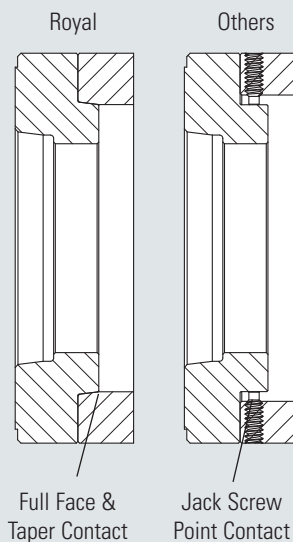

All Royal CNC Collet Chucks mount quickly, easily, and accurately due to our exclusive Bolt & Go™ mounting interface.

Many Royal chuck models mount directly to the lathe spindle without the need for an adapter plate. However, for models that do use a plate, a precision-ground tapered fit between the plate's male pilot and chuck body's female recess **ensures a consistent, near-perfect fit without the need for any adjustment.** This precision fit also enhances overall system rigidity by providing both face and taper contact.

Other chuck manufacturers use a less precise approach. Instead of providing a near-perfect tapered interface between the chuck body and plate, they rely on a loose fit between a male cylindrical pilot on the plate and an oversized bore within the chuck body. Because there is clearance between these two components, jack screws located around the circumference must be used to radially true-up the chuck on the plate. This process of using the jack screws and an indicator to dial out the runout each time a chuck is mounted wastes valuable production time. The rigidity of this design is also significantly less due to the limited point-contact provided by the screws against the pilot as compared to the full-contact tapered fit of the Royal Bolt & Go™ interface.

Knock 30 Minutes Off Your Setup Time with Royal Bolt & Go™

WHY CHOOSE ROYAL CNC COLLET CHUCKS?

Precision-Made in USA

- Every Royal CNC collet chuck is completely manufactured in our modern factory on state-of-the-art automated CNC equipment.
- All chucks, sleeves, adapter plates, collets, etc., come off of our gantry-loaded multi-tasking machines complete – eliminating the accuracy and quality issues often associated with multiple setups/operations.
- All grinding takes place on precision Swiss-made CNC grinders that enable multiple features to be ground in a single setup, resulting in near-perfect tolerances and **ensuring absolute consistency from part to part.**
- Royal Products is an ISO9001 registered company dedicated to continuous improvement. Every process is documented and followed down to the smallest detail for consistent quality – every time.



Same-Day Shipping



Our product availability is second to none. Over **94% of all Royal CNC collet chucks ship complete the same day they are ordered**, and the remainder ship either the next day, or as specified by the customer.

We stock more than 700 chucks at any given time to ensure that we will always have what our customers need, when they need it.

Outstanding Support



Royal maintains a fleet of fully-equipped mobile showrooms designed to bring solutions to our customers' doorsteps. To schedule a visit to your company, please call 1-800-645-4174.

- Royal's knowledgeable team of applications engineers makes it very easy for you to do business with us. When you call Royal, the person you speak with will be a workholding expert, and if we can't offer you the best solution for your application, we'll do our best to recommend a company that can – even if it's competitor!
- Royal CNC Collet Chucks are sold through a **select network of the country's top industrial and machine tool distributors.** We also have strong relationships with all of the major machine tool builders and importers to make sure that our products seamlessly interface with their machines.
- With over forty factory-trained account managers strategically located throughout North America, our highly-qualified field support team is always ready and willing to serve you.

WHY CHOOSE ROYAL CNC COLLET CHUCKS?

We Make It Easy

- All chucks include everything needed for installation, (even the wrenches). We strive to give our customers “the mint on the pillow” treatment.
- Through the past thirty years of gathering machine tool specifications and working closely with all of the major machine tool builders, Royal Products has developed a huge database of drawtube specifications, virtually eliminating the need for a customer to ever measure a machine.
- We now stock over 300 of the most common drawtube connector models, and non-stock connectors are made very quickly from semi-finished blanks.
- All Royal CNC collet chucks come packaged in specially designed heavy-gage boxes with form-fitting foam inserts to provide complete protection of all contents.



Risk-Free Performance Guarantee

In addition to providing superior quality, service, support, and deliveries, Royal CNC Collet Chucks also carry an industry exclusive risk-free performance guarantee. This no-risk guarantee allows our customers to run a collet chuck on the toughest jobs in their shop for 45-days, and if they are not 100% satisfied with its performance, we will take it back and arrange for a full refund through their distributor.

When you buy a CNC collet chuck from Royal Products, you can have **complete confidence** that we will not let you down. For over 70 years, Royal has been recognized as one of the most reliable and trusted suppliers in the metalworking industry. We're here for you today, and we'll be here for you tomorrow.

- ✓ Smarter Design
- ✓ Better Quality
- ✓ Outstanding Support

**Risk-Free
PERFORMANCE
Guarantee**

- ✓ Same-Day Shipping
- ✓ No Hassles
- ✓ Risk-Free Guarantee



Check out the Royal Quick-Grip™ CNC Collet Chuck Video at www.colletchucks.com